

OVERALL ASSEMBLY DIMENSIONS:

EXTERNAL - 190 x 120 x 60

INTERNAL - 185 x 115 x 53.5

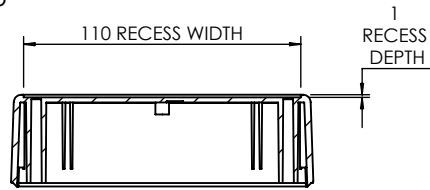

SECTION B-B

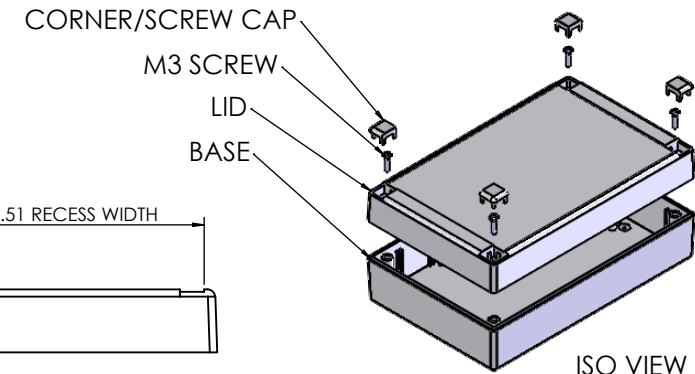
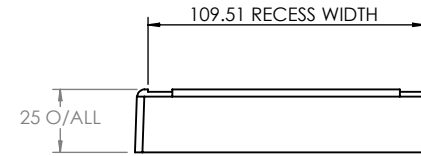

ISO VIEW
1:5

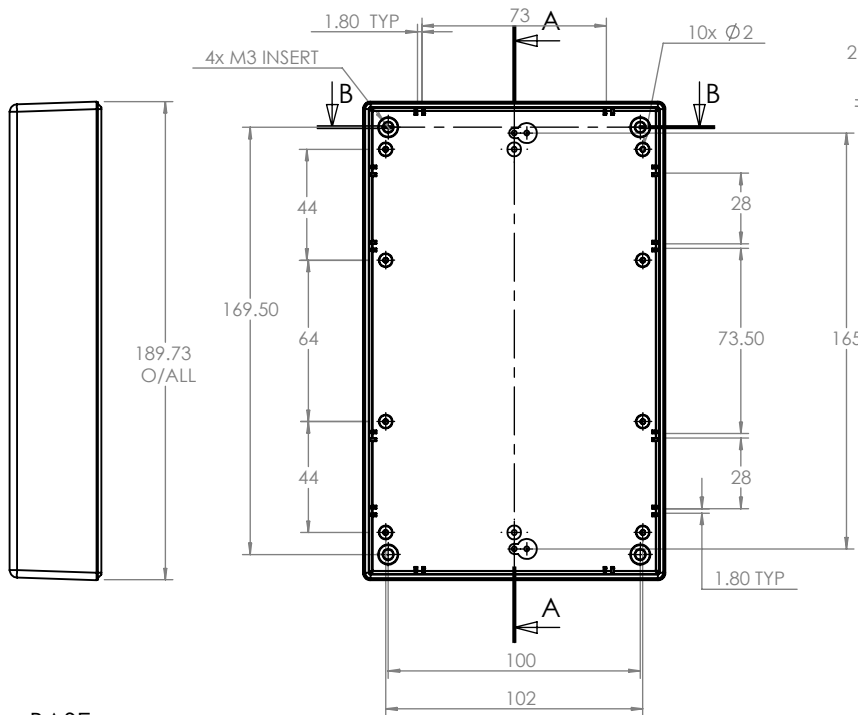

BASE

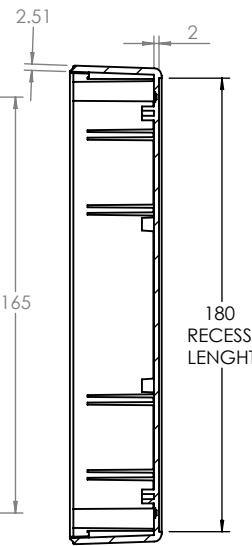

SECTION A-A

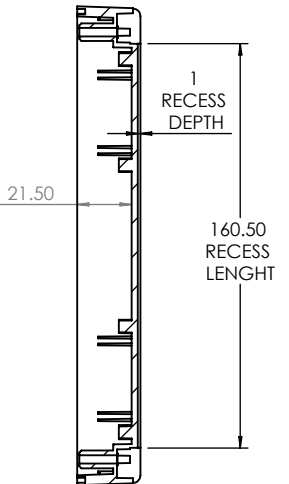
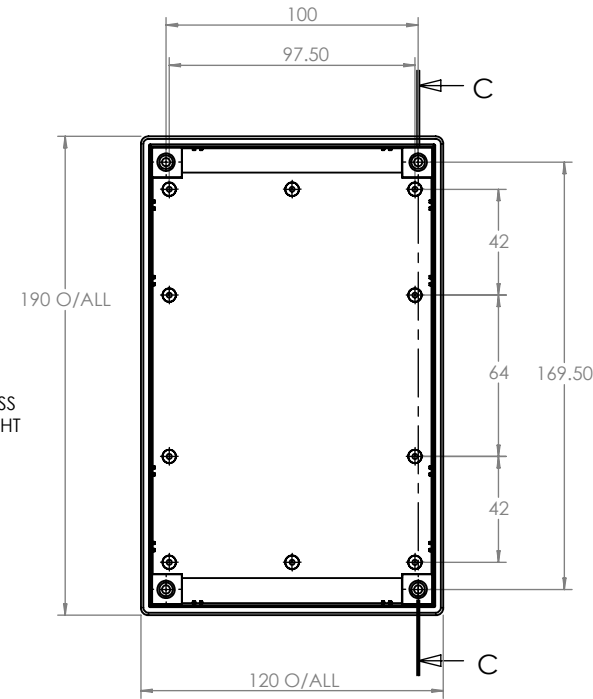

SECTION C-C

LID

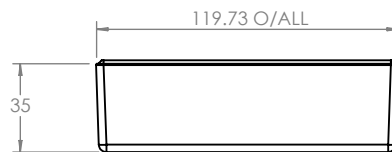

<p>CAMDENBOSS JAMES CARTER RD, MILDENHALL, SUFFOLK. IP28 7DE TEL: 01638 716101 FAX: 01638 716554 EMAIL: Sales@CamdenBoss.com WEB: www.CamdenBoss.com</p>		UNLESS OTHERWISE SPECIFIED: DIMENSIONS ARE IN MILLIMETERS		DO NOT SCALE DRAWING	REVISION. C
		GENERAL TOLERANCES +/- 0.2		TITLE: ASSEMBLY DRG FOR RECESS DESIGNER CASE SIZE 7 BLACK	
FINISH. LIGHT SPARK		MATERIAL. UL 94 - V0 ABS		DWG NO. CRDCB0007	
DRAWN	IAN PAGANO	SIGNED	I.P.	DATE	19/10/15
CHK'D	DAN SMALLEY	DIS		DATE	16/03/17
PROJECTION.				SCALE. 1:3	SHEET 1 OF 1

A4