

SECTION A-A

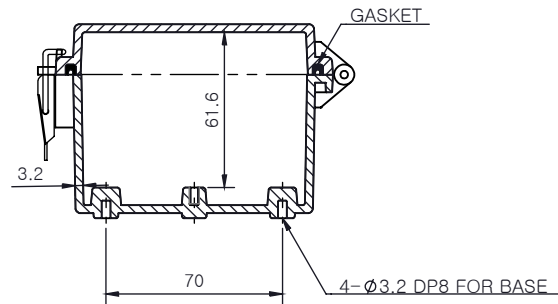
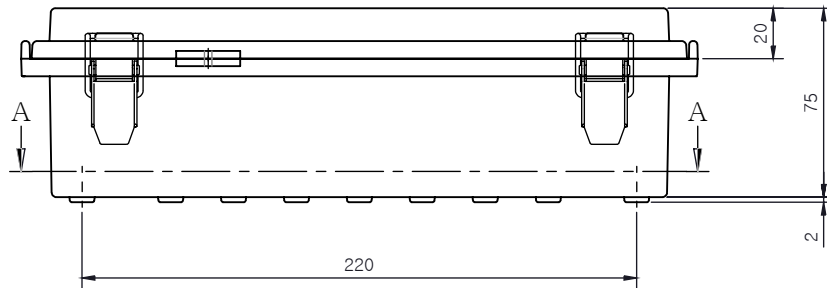

SECTION B-B

| Part Number | Description |
|-------------|---------------------------|
| CHDX8-221 | Polycarb, Solid Lid |
| CHDX8-221C | Polycarb, Transparent Lid |
| CHDX8-321 | ABS, Solid Lid |
| CHDX8-321C | ABS, Transparent Lid |

| | | | | | | | | |
|---|--|--|--|--|---|--|------------------------|--|
| JAMES CARTER RD, MILDENHALL, SUFFOLK. IP28 7DE TEL: 01638 716101 FAX: 01638 716554 EMAIL: Sales@CamdenBoss.com WEB: www.CamdenBoss.com | | | UNLESS OTHERWISE SPECIFIED: DIMENSIONS ARE IN MILLIMETERS | | GENERAL TOLERANCES +/- 0.2 | | REVISION. ○ | |
| | | | FINISH. Lid - Gloss, Base - Light Spark | | TITLE: X8 Series Heavy Duty Hinged Enclosure, 260x110x75 | | | |
| | | | COLOUR. Light Grey | | DWG NO. | | CHDX8 (260x110x75) | |
| DRAWN Jack Dickinson | | | SIGNED J.H.D | | DATE 08/12/17 | | MATERIAL. See table | |
| CHKD Alwin B.K | | | SIGNED ABK | | DATE 08/12/17 | | PROJECTION. | |
| | | | SCALE: 1:3 | | SHEET 1 OF 1 | | DO NOT SCALE DRAWING | |