

# LEDs & INDICATORS

## 504 05 Series

- Snap fit body for panel thicknesses 0.5-3.5mm, panel cut-out 13mm diameter
- 6.3mm quick-connect terminals as standard
- Neons 240V 0.8mA, as standard
- Polycarbonate lens/body and brushed chrome bezel
- Maximum working temperature 105°C
- Red, green, amber lens colour options as standard



TYPE NO.	IND504	2	03	240	- T /	XXX
504 Series Indicator	504					
Lens Type	2					
6.3mm quick-connect terminal	03					
Neon 240V 0.8mA, red wire	240					
Transparent lens	T					
Lens colour Red	RED					
Lens colour Green	GRN					
Lens colour Amber	AMB					

### Dimensions

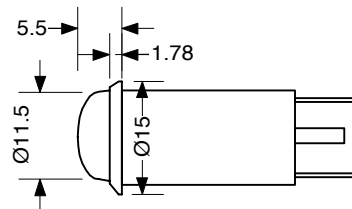

## 503 A Series

- Press fit body for various panel thicknesses, panel cut-out 8mm diameter
- Available with solder tags and wire termination
- Operating life 50,000 hours
- Polycarbonate lens/body and brushed chrome bezel
- Maximum working temperature 105°C
- Red, green, amber lens colour options as standard
- Custom wire lengths and specification to order
- Removable collar fits to rear of panel for improved retention



TYPE NO.	IND503	2	X	LED2	-XXX	- T /	XXX
503 Series Indicator	503						
Lens cylinder curved sides	2						
Stripped wire 280mm long	4						
Solder tag termination	2						
LED, neon-replacement, 240V 1mA	LED2						
Neon 125V 1mA, blue wire	125						
Neon 240V 0.8mA, red wire	240						
Transparent lens	T						
Lens colour Red	RED						
Lens colour Green	GRN						
Lens colour Amber	AMB						

### Body Dimensions

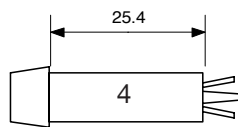

Stripped Wire

### Lens

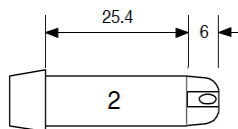

Solder Tag